

# Sean Heaney

HOME'S & PROPERTY



**Meadway**  
High Barnet, Barnet, EN5 5JX  
£750,000

4 2 2 D

## Meadway

High Barnet, Barnet, EN5 5JX

A SPACIOUS and BEAUTIFULLY EXTENDED 4 Bedroom SEMI DETACHED FAMILY HOME in this popular location being within walking distance of HIGH BARNET UNDERGROUND and TOWN CENTRE as well as highly regarded local schools. The property is arranged over 3 floors and consists of a welcoming hallway, GUEST CLOAKROOM, lounge, kitchen/dining room plus a snug area, UTILITY ROOM, 3 bedrooms, family bathroom, additional separate w/c and a PRINCIPAL BEDROOM with SHOWER ROOM to the second floor. Externally there is a GENEROUS GARDEN 76' in length, a LARGE DETACHED GARAGE, OFF STREET PARKING and a shared driveway.

EPC : D

### GROUND FLOOR

#### Entrance Hall

#### Reception Room

17' x 12' (5.18m x 3.66m)

#### Kitchen/Dining Room

22'10 max x 17'9 max (6.96m max x 5.41m max)





**Utility**  
7' x 6'10 (2.13m x 2.08m)

**Guest Cloakroom**

**FIRST FLOOR**

**Landing**

**Bedroom 2**  
12'7 x 11'2 (3.84m x 3.40m)

**Bedroom 3**  
13'10 max x 11' max (4.22m max x 3.35m max)

**Bedroom 4**  
8' x 7'7 (2.44m x 2.31m)

**Family Bathroom**

**Separate WC**

**SECOND FLOOR**

**Principal Bedroom**  
16'7 max x 12'2 max (5.05m max x 3.71m max)

**Family Shower Room**

**GARDEN**  
approx 76'2 x 25'4 (approx 23.22m x 7.72m)

**GARAGE**  
16'3 x 8'8 (4.95m x 2.64m)



## Floor Plan

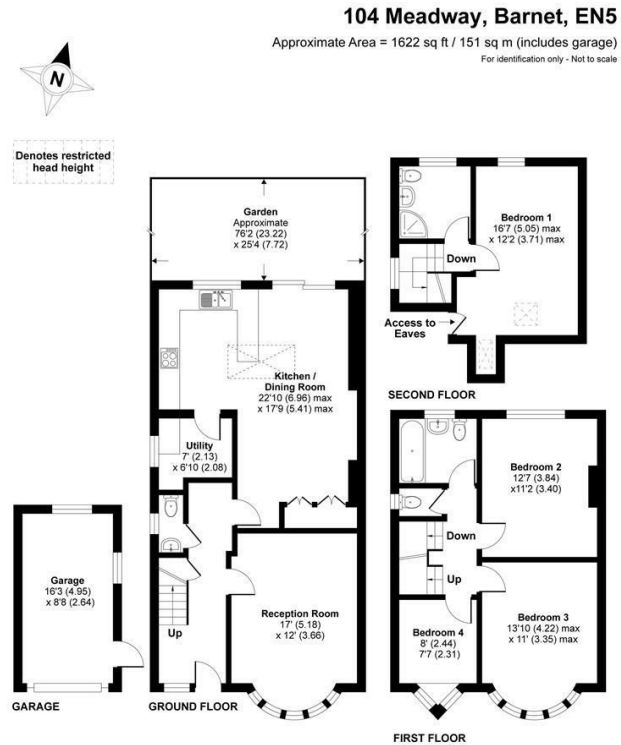

RICS Certified Property Measurer  
 Floor plan produced in accordance with RICS Property Measurement Standards incorporating International Property Measurement Standards (IPMS2 Residential). © richrecom 2020. Produced for Sean Heaney Homes & Property. REF: 625319

## Viewing

Please contact our Barnet Office on 0208 441 7173 if you wish to arrange a viewing appointment for this property or require further information.

1. Please note that we have not tested any apparatus, equipment, fixtures, fittings or services, and so cannot verify they are in working order, or fit for their purpose. A buyer is advised to obtain verification from their Solicitor or Surveyor.
2. References to the tenure of a property are based on information supplied by the seller. The agent has not had sight of the title documents. A buyer is advised to obtain verification from their Solicitor.
3. Room measurements have been made using a Laser Meter. Complete accuracy cannot be guaranteed and therefore the room sizes given should be regarded as being approximate.
4. Photographs are for illustration only and may depict items which are not for sale or included in the sale of the property.
5. Floor plans remain copyright of Sean Heaney Estate Agents and are not to be copied in part or full without written consent, are provided for illustrative purposes only and are not to scale.

## Area Map



## Energy Efficiency Graph

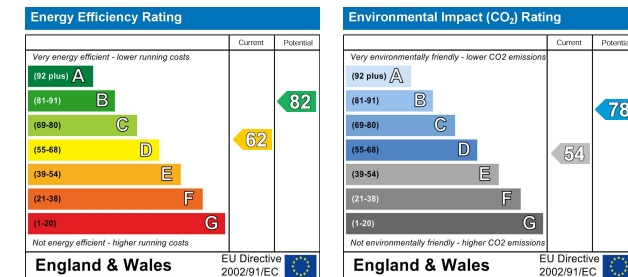

Highstone House, 165 High Street, Barnet, Hertfordshire, EN5 5SU

T: 0208 441 7173 E: sales@seanheaney.co.uk W: www.seanheaney.co.uk